

# INSTRUCTION MANUAL



Contact

**BUSH WINCHES AND ANCHORS PTY LTD**

PO Box 1719

Subiaco Western Australia 6904

Email: [info@bushwinch.com.au](mailto:info@bushwinch.com.au)

## CONGRATULATIONS

Congratulations on your purchase of the *Bush Winch*.

You have chosen a very versatile and practical vehicle recovery system which gives you self reliance. Keep the *Bush Winch* with you while travelling or working and have the peace of mind of knowing that should you get stuck you have the solution.

This simplicity of this vehicle recovery system is the culmination of years of testing. It combines technical innovation with superior quality materials to ensure many years of trouble free use.

Please take the time to read and understand this Instruction Manual. Familiarise yourself with the operation of the *Bush Winch* by testing and practicing in controlled situations. There is no better substitute than actual hands-on experience.

Thank you - Enjoy your travels.

# CONTENTS

	Page
Winching safely	1
1. The wheel nuts	2-3
2. Assess the situation	4
3. Attaching the <i>Bush Winch</i>	5
4. Attaching the winch rope	6
5. Winching	7-8
6. Anchoring	9
7. Joining and attaching the winch rope	10



# WINCHING SAFELY

*Winching a vehicle is an inherently dangerous procedure.  
Consider your actions carefully.*

Pose these questions:

1. What would happen to the vehicle if the winch the rope or the anchor fails at some point during the pull?
2. Is there a risk of injury or damage if the winch rope or anchor fails?
3. Stand clear and to the side of a vehicle being winched.
4. Winch slowly. Stop and check your progress as you go.
5. Do not leave the **Bush Winch** attached to the vehicle when driving.



S. Melville 2006



# 1. THE WHEEL NUTS

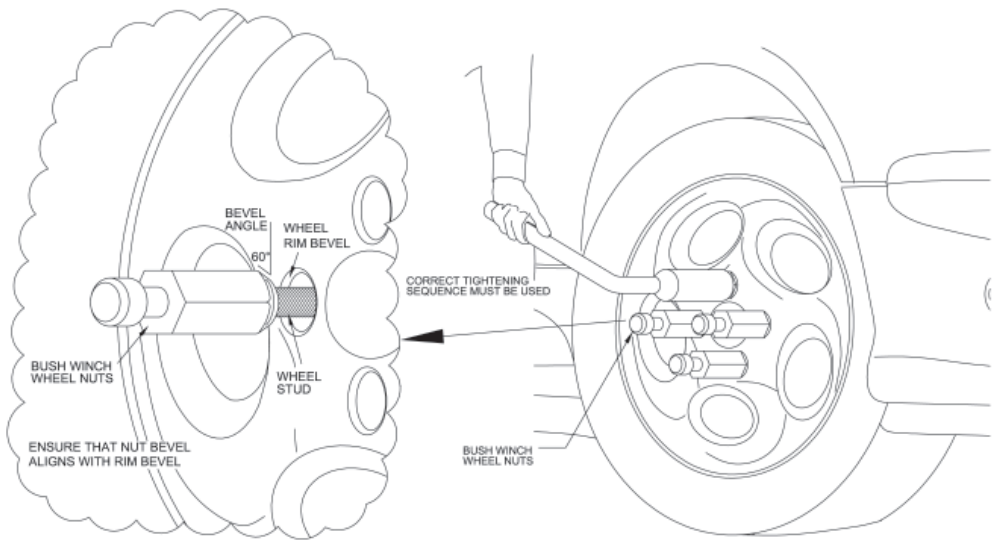

## IMPORTANT NOTICE AND FACTS

It is essential that the wheel nuts supplied with the *Bush Winch* fit and seat into the wheel rim in exactly the same manner as the wheel nuts supplied by the manufacturer are fitted to your vehicle. Failure to ensure correct fitment of the wheel nuts may result in your wheel rim becoming loose.



# 1. THE WHEEL NUTS Cont....

1. Replace the wheel nuts on your vehicle with the wheel nuts supplied with the **Bush Winch**. They should be tightened to the torque setting recommended by the vehicle manufacturer for the original wheel nuts.
2. You may need to remove the hub caps or dust covers on your wheel rim to fit the new wheel nuts.
3. You can leave the **Bush Winch** wheel nuts on permanently. Regularly check that the wheel nuts have remained secure.

The **Bush Winch** also relies on the wheel nuts to be properly seated and tightened to provide secure attachment.



## 2. ASSESS THE SITUATION



**Are you bogged? Has your vehicle lost traction?**

**Consider this first:**

1. Which wheels have lost traction?
2. What can you use as anchor points and where are they?
3. Is it best to winch forwards or backwards?
4. In a 4WD is it best to put the winches on the front or the back wheel?
5. Do you need to use both winches or only one?



### 3. ATTACHING THE BUSH WINCH

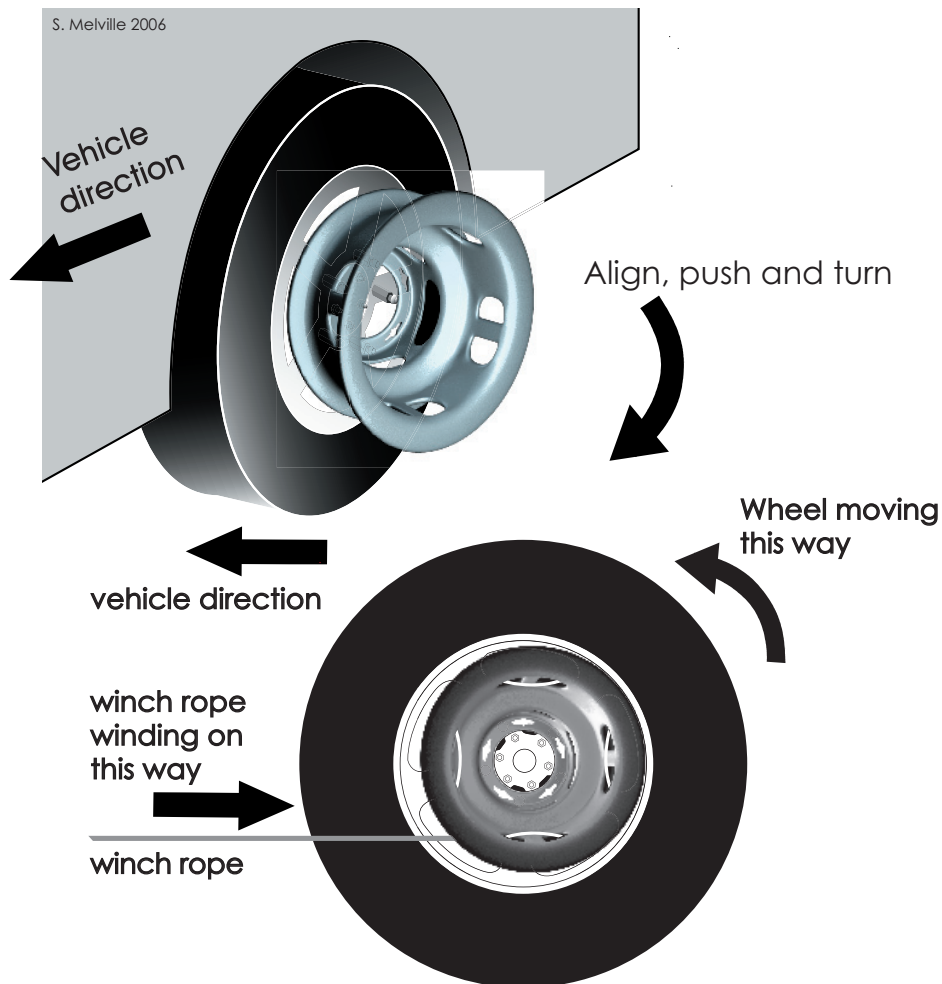

1. Align the holes in the **Bush Winch** base plate and then push and twist.
2. The **Bush Winch** is twisted on in the opposite direction to the wheel rotation.
3. Only attach the **Bush Winch** when required. Do not drive with the **Bush Winch** permanently attached.



## 4. ATTACHING THE WINCH ROPE

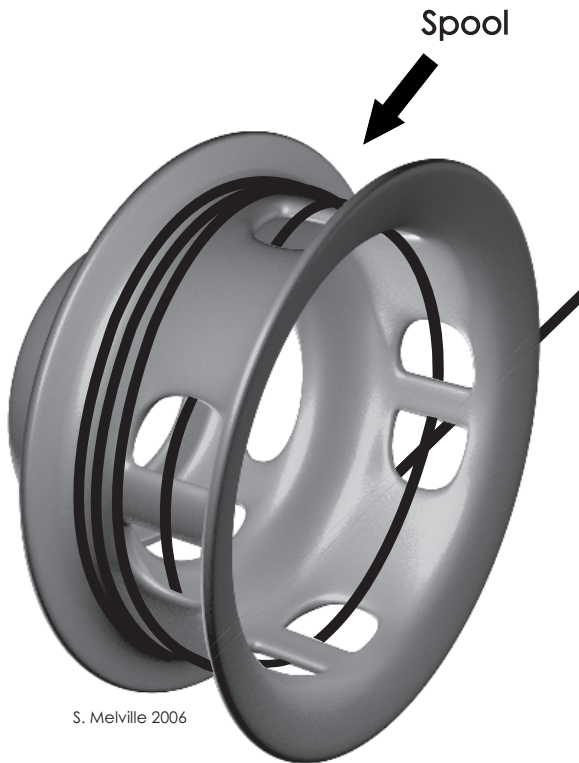

S. Melville 2006

### IMPORTANT NOTICE AND FACTS

- The winch rope supplied is specifically graded, coloured and designed for use with the Bush Winch. Do not use any other ropes, chains, webbing, straps or steel cable.
- The Winch rope supplied is designed to be the weakest component in the winch system and will break at 2000kg (4409lbs) or 3200kg (7054lbs) load.
- The Winch rope is a very light weight non-stretch variety and therefore if it were to break it has very little elastic action.

1. Weave the winch rope through the cut-outs in the spool and then put on another 3 full wraps onto the spool. Friction is used to keep the winch rope from slipping on the spool.
2. Do not tie the end of the winch rope to any of the cut-outs on the Winch.
3. Do not use shackles or knots to attach the rope to the winch.
4. Extra lengths of winch rope can be added to the winch line. The spool will accept about 60 metres (197 feet) of rope.



# 5. WINCHING



## IMPORTANT NOTICE AND FACTS

- Vehicles with ABS (Automatic Braking Systems) or TC (Traction Control) work well with **Bush Winch**. Follow the manufacturers recommendations if any advice is given on temporarily disengaging the TC in a bog or slippery surfaces.
- Vehicles which have a manually selected option for engaging a Differential Lock between the front and back axles should engage this before winching begins.
- Vehicles with a Differential Lock on the axles can choose to use **Bush Winch** on one side alone if the load or angle of pull is not too severe.



# Winching Cont...

1. Use the back wheels as a preference as this will keep the load off the steering wheel and allow better manoeuvrability.
2. Take any slack out of the winch rope by winding it up on to the winch spool.
3. Drive the vehicle slowly and steadily – you have ample power at very low engine speeds.
4. The **Bush Winch** and wheels work together to get you out of a bog. If the winch rope is only winding onto the **Bush Winch** on one side it means the opposite wheel has already got traction and is helping to get you out of the bog. The winch line on this side may stay loose and be lying on the ground as the vehicle moves.
5. If traction is lost intermittently from one wheel to the other, the wheels can only spin until the winch line has tightened up again. Check that the winch rope is continuing to wind onto the **Bush Winch**.
6. Stop and check progress at any stage.



# 6. ANCHORING

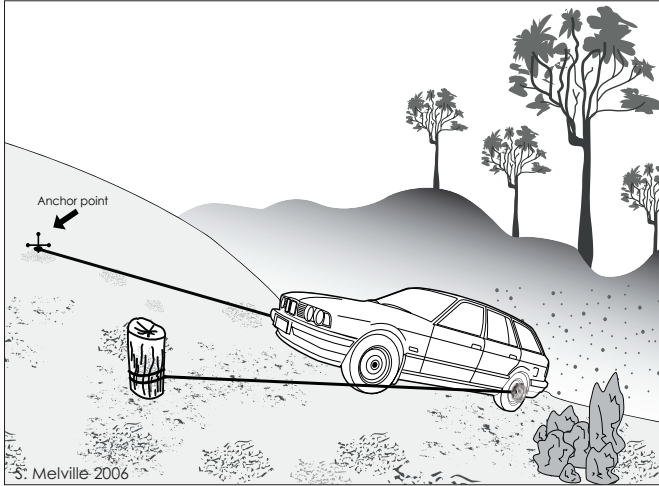

The *Bush Winch* works best with anchor points located parallel or at an acute angle from the side of the vehicle. Use other vehicles, natural anchors or ground anchors to pull from.

Pulling from separate anchor points spreads the load and often allows weaker anchor points to be used.

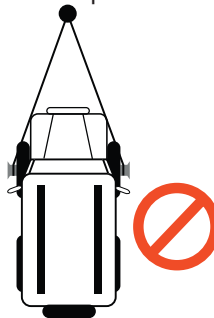

**INCORRECT**  
**ANCHORING**

Do not pull to the same anchor point if it means you will run over the winch rope.



# CORRECT ANCHORING

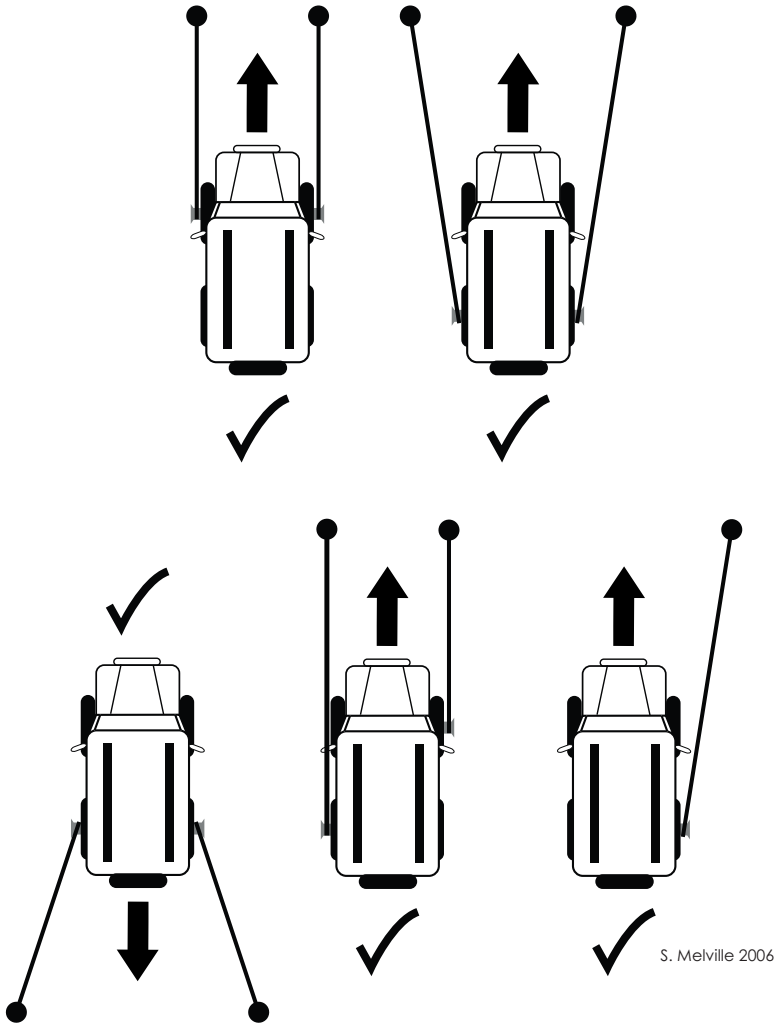

The vehicle can be anchored in any of the above variations.



# 7. JOINING AND ATTACHING THE WINCH ROPE

Only use the *Bush Winch* rope supplied (it comes complete with an eye at each end for the purpose of joining or attaching to anchors). It is non stretch and specially graded for strength to match the *Bush Winch*.

## DO NOT

- Use webbing, chain or cable on the *Bush Winch*.  
or
- Put knots in the Winch rope.

## JOINING THE WINCH ROPE

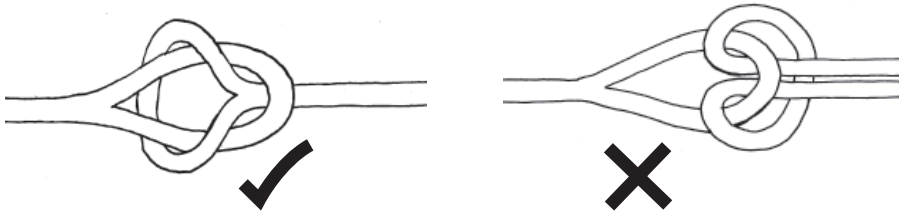

## UNDOING THE WINCH ROPE

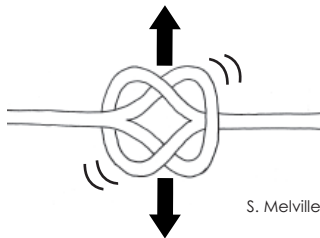

S. Melville 2006

Pull and jerk the eyes open until knot loosens.



## Warranty and Disclaimer

- Activities involving the use of any winch are inherently dangerous. Before using the *Bush Winch* become acquainted with its use and understand the risks you are taking. You are responsible for your own actions and must accept the risks involved.
- Bush Winches and Anchors Pty Ltd (“BWA”) will not accept any loss or damage to property or person as a result of use of the Bush Winch.
- BWA makes no specific representation as to the suitability of the *Bush Winch* for your own uses.
- BWA extends a warranty on the Winch, the Winch Rope and the Wheel Nuts where it can be demonstrated the product is faulty.



